



**BROCELIANDE  
ATLANTIQUE**  
GROUPEMENT HOSPITALIER  
Vannes - Auray

DITP

---

Implantation des coffrets  
d'énergies

## Plan site de Vannes



## Plan site d'Auray

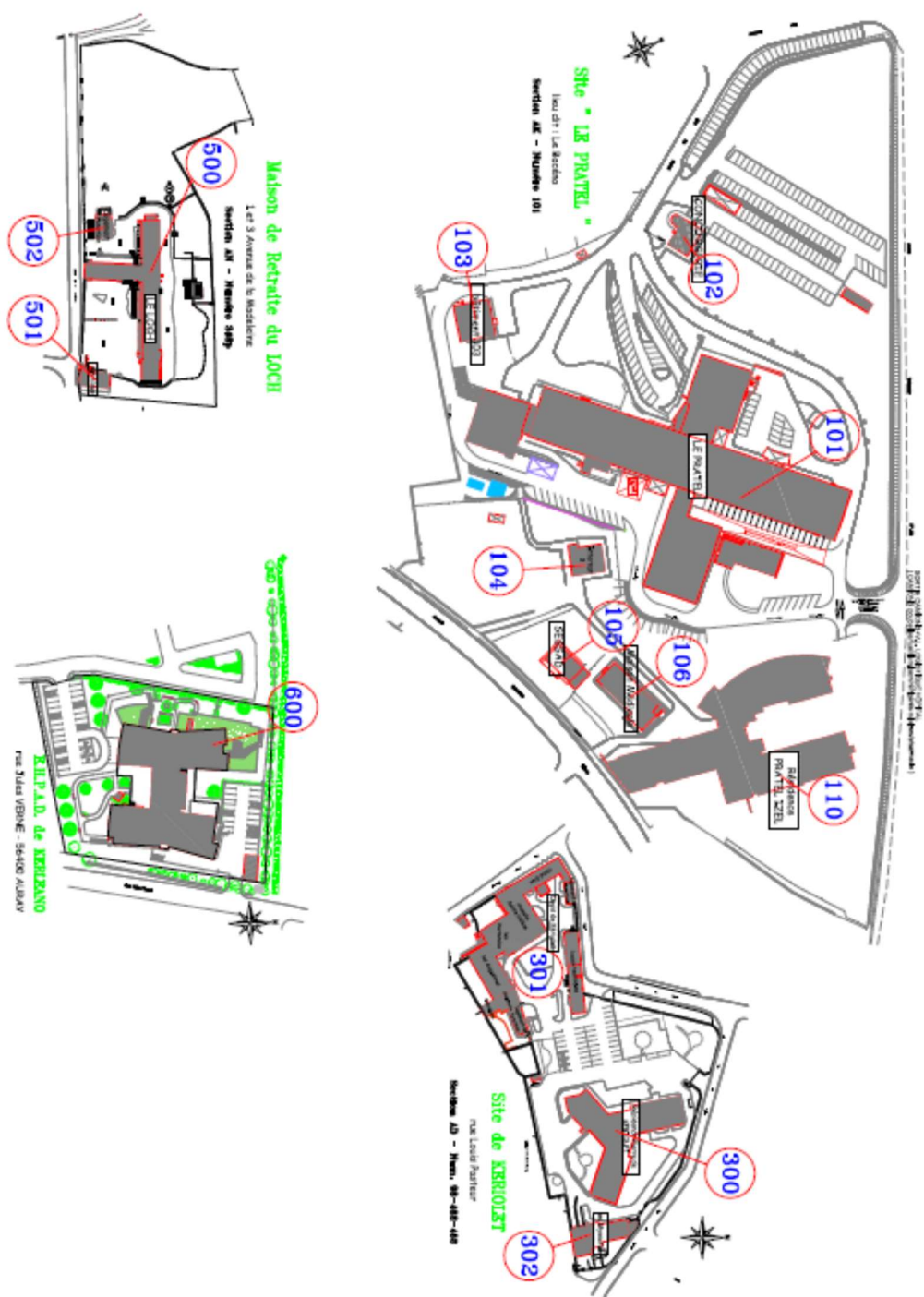

<b>SITE LE PRAETEL</b>	
101	LE PRAETEL : Orto, 0 Acoustique/Constr. Médicre A & B Routologie Réhabilitation (orthodontologie) Service Social MFR - SSR 1 - SSR 2
102	CONCERNE CLIC - VMA
103	B 103 vite
104	INTENDANT
105	SEMAIR DE SENS A DOMICILE
106	Maison MÉDICALE DE GARIE
110	SAINTES PRAETEL DEL BIMPD - USLD
<b>SITE DE KERIOLET</b>	
300	MAISON FIDUCIE DE KERIOLET DEPUIS - USLD
301	LOIS DE KERIOLET Hôtel Dieu / les Augustines Chapelle Sainte Hélène / ...
302	LES UNIFORMES
<b>SITE DU LOCH</b>	
500	LE LOCH : Démocratie
501	ARCHIVES
502	LIVREMENTS DE FONCTION
<b>SITE DE KERLEANO</b>	
600	SAINTES KERLEANO

## Positionnement des coffrets d'énergie dans les bâtiments

Les coffrets d'énergie sont symbolisés par ce repère : 

## Site de Vannes

B97 – Poste de livraison

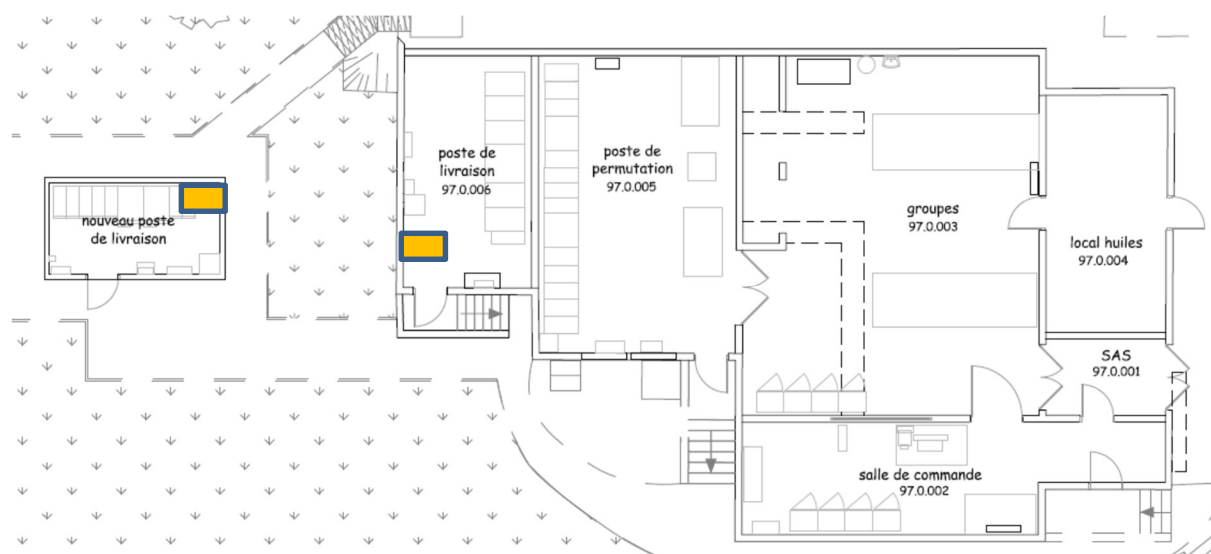

B30 – Chirurgie



Plan de répartition des locaux de la salle informatique. Le plan est divisé en plusieurs zones fonctionnelles :

- TGBT ACA / RADIOTHERAPIE** (20.0.1108) : 24.80m<sup>2</sup>
- TGBT PTM 2** (20.0.1062) : 22.31m<sup>2</sup>
- TGBT PTM 1** (20.0.1061) : 17.51m<sup>2</sup>
- BATTERIES DE CONDENSATEUR** (20.0.1063) : 6.71m<sup>2</sup>
- TG0 + ONDULEUR** (20.0.1064) : 16.22m<sup>2</sup>
- LOCAL ELEC DIVERS** (20.0.1102) : 5.56m<sup>2</sup>
- LOCAL HTA PTM2** (20.0.1129) : 21.84m<sup>2</sup>
- LOCAL HTA PTM1** (20.0.1120) : 21.85m<sup>2</sup>
- LOCAL INFORMATIQUE Salle Serveur** (20.0.1123) : 25.65m<sup>2</sup>
- Zone centrale** (20.0.1101) : 72.65m<sup>2</sup>

Le plan inclut également des portes, des fenêtres, des escaliers et des zones de circulation.

The architectural floor plan shows a building with several rooms and outdoor spaces:

- Cour anglaise**: A small courtyard area on the left.
- cour anglaise terrasse**: A terrace area adjacent to the courtyard.
- garage fondéges**: A garage area at the top left.
- contrôle d'entrée**: An entrance control area.
- escalier**: A staircase area.
- escalier & ascenseur**: A combined staircase and elevator area.
- chambre**: A bedroom area.
- salle de bain**: A bathroom area.
- salon**: A living room area.
- kitchenette**: A small kitchen area.
- chambre**: Another bedroom area.
- chambre**: A third bedroom area.
- chambre**: A fourth bedroom area.
- chambre**: A fifth bedroom area.
- chambre**: A sixth bedroom area.
- chambre**: A seventh bedroom area.
- chambre**: An eighth bedroom area.
- chambre**: A ninth bedroom area.
- chambre**: A tenth bedroom area.
- chambre**: An eleventh bedroom area.
- chambre**: A twelfth bedroom area.
- chambre**: A thirteenth bedroom area.
- chambre**: A fourteenth bedroom area.
- chambre**: A fifteenth bedroom area.
- chambre**: A sixteenth bedroom area.
- chambre**: A seventeenth bedroom area.
- chambre**: An eighteenth bedroom area.
- chambre**: A nineteenth bedroom area.
- chambre**: A twentieth bedroom area.
- chambre**: A twenty-first bedroom area.
- chambre**: A twenty-second bedroom area.
- chambre**: A twenty-third bedroom area.
- chambre**: A twenty-fourth bedroom area.
- chambre**: A twenty-fifth bedroom area.
- chambre**: A twenty-sixth bedroom area.
- chambre**: A twenty-seventh bedroom area.
- chambre**: A twenty-eighth bedroom area.
- chambre**: A twenty-ninth bedroom area.
- chambre**: A thirtieth bedroom area.
- chambre**: A thirty-first bedroom area.
- chambre**: A thirty-second bedroom area.
- chambre**: A thirty-third bedroom area.
- chambre**: A thirty-fourth bedroom area.
- chambre**: A thirty-fifth bedroom area.
- chambre**: A thirty-sixth bedroom area.
- chambre**: A thirty-seventh bedroom area.
- chambre**: A thirty-eighth bedroom area.
- chambre**: A thirty-ninth bedroom area.
- chambre**: A fortieth bedroom area.
- chambre**: A forty-first bedroom area.
- chambre**: A forty-second bedroom area.
- chambre**: A forty-third bedroom area.
- chambre**: A forty-fourth bedroom area.
- chambre**: A forty-fifth bedroom area.
- chambre**: A forty-sixth bedroom area.
- chambre**: A forty-seventh bedroom area.
- chambre**: A forty-eighth bedroom area.
- chambre**: A forty-ninth bedroom area.
- chambre**: A fiftieth bedroom area.



The floor plan illustrates the layout of the 1st floor, featuring several key areas:

- Local autocom répareur gal:** 23.3 m², 24ET011, LRM.
- Local onduleur 1:** 15 m², 24ET009, LRM.
- Local onduleur 2:** 15 m², 24ET004, LRM.
- Local TP 1:** 38.2 m², 24ET010, LRM.
- Local TGO:** 9.9 m², 24ET008, LRM.
- Local TP 2:** 40.1 m², 24ET003, LRM.
- Central Staircase:** 105.8 m², 24ET007, LRM.
- Technical Rooms (TECHN):** Multiple rooms for technical equipment, including a large one (105.8 m², 24ET007, LRM) and several smaller ones (e.g., 19.9 m², 24ET001, LRM).
- Circulation:** Areas for movement between rooms, including a central corridor and a staircase.

patio

ACCES LOCAUX TECHNIQUES

Stock 2  
90/RB/046  
58.36m²

Stock 1  
90/RB/045  
24.84m²

Sous Station Chauffage  
90/RB/022

Centrale Compresseurs  
90/RB/023

Transformateur  
90/RB/020

Stock tampon

Stock 3  
90/RB/019

90/RB/014

a.s.c.

circulation  
16.69m²  
90/RB/011

## B70 - Decker

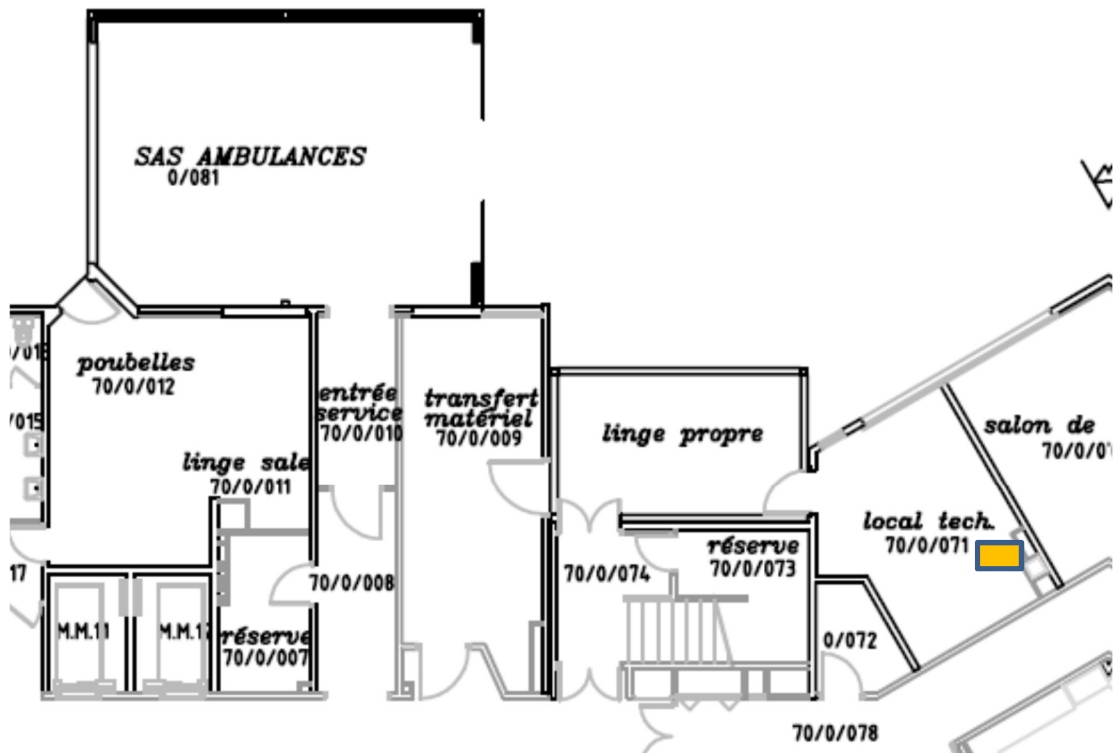

## B85 – Maison du Lac





## Site d'Auray

B101 – Le Pratel

